

Front Seat Linkage

Recline Motor Replacement

CAUTION: Wear gloves to remove and install the recline motor.

NOTE:

- Take care not to scratch the seat cover.
- Remove the front seat (see page 20-46).
- Remove the seat cushion and seat-back (see page 20-46).

1. Remove the recline memory switch (fully power adjustable only).

NOTE: Take care not to damage the recline memory switch.

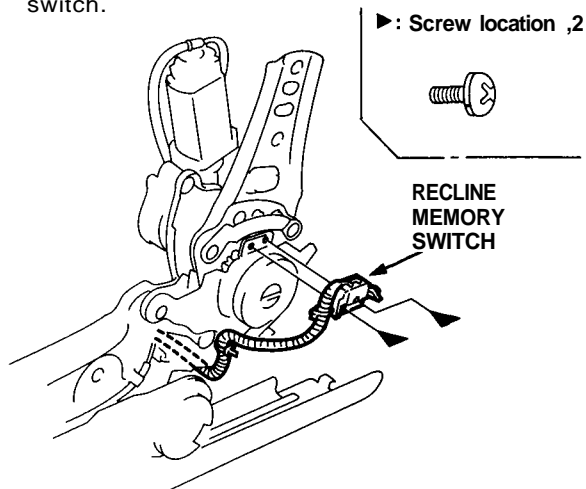

2. Remove the switch plate and screws.
3. Disconnect the connector, then remove the recline motor.

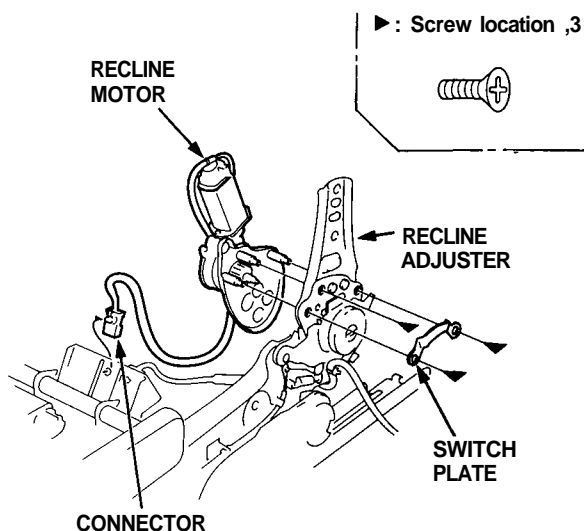

4. Installation is the reverse of the removal procedure.

NOTE:

- Before installing the recline motor, apply grease (molybdenum grease) to the gear portion.

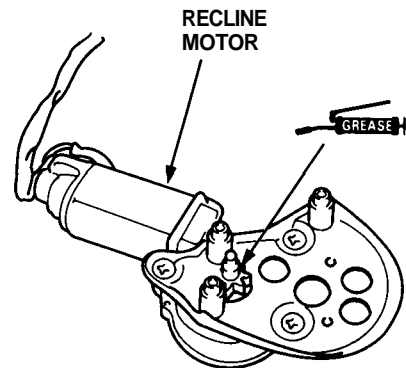

- After installing the recline motor, apply liquid thread lock to screws, then tighten the screws.

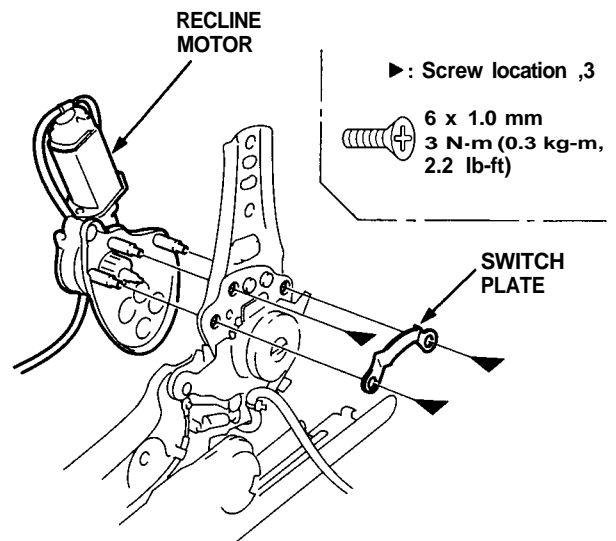

- Make sure the connector is connected properly.
- Check the recline adjuster operation.